



## Technical Guide



# HADLEIGH

## True Handleless Rail System

Release date:

July 2020

**Please Note:** The information shown in this literature is accurate as at the date of release shown but may be subject to changes after such date. Please therefore ensure that you are viewing the most current product available and check with us if you have any doubt about the suitability of the product or accuracy of the information shown.

## IMPORTANT PLEASE NOTE

The information contained in this literature is for illustrative purposes only to assist in choosing your desired kitchen. While we endeavour to keep the information up to date and correct we do not make any representations or warranties of any kind, express or implied, about the completeness, accuracy, reliability and suitability of the doors and products that appear in this literature.

We aim to showcase as many different items as possible and therefore some products have been installed and photographed purely to show as many of our product features as possible and they should not be taken as an example of how they are intended to be installed in real kitchen installations.

**It is therefore the responsibility of the installer to check the corresponding manufacturer's installation information and the manufacturer's technical information to ensure this is up to date and to ensure that the products can be fitted in a way they are displayed and the products are suitable for your requirements.**

We specifically exclude any liability in this regard unless the products are fitted in accordance with the specifications we supply and the manufacturer's installation recommendations are used in a way recommended by the manufacturer and in accordance with the manufacturer's technical information provided.

The information shown in this literature is accurate as at the date of print/release shown on such information but it may be subject to changes after such date. Please therefore ensure that you are viewing the most current product information available and check with us if you have any doubt about the suitability of the product or accuracy of the information shown.

We are proud that all our products that we sell are covered by a statutory warranty but this does not stop all our products naturally ageing over time. As a result of this natural ageing process we are therefore unable to provide an identical colour finish to the existing products you have purchased from us with any products that we supply you from the same product line. In such event our liability will be limited to the purchase price paid for the product you are seeking to replace.

Due to the limitations on photographic reproduction, colours may differ slightly from the actual products shown. Please note that board matches listed with the doors are a suggestion only and better board matches may be available on the market, it is up to the individual to decide on the suitability.

---

**Please Note:** The information shown in this literature is accurate as at the date of print/release shown on such information but it may be subject to changes after such date. Please therefore ensure that you are viewing the most current product available and check with us if you have any doubt about the suitability of the product or accuracy of the information shown.



# HADLEIGH TRUE HANDLELESS RAIL SYSTEM



Hadleigh true handleless kitchen  
with matt Anthracite doors

## Product Information

### Description

Hadleigh true handleless rail system

### Finish / Material

Aluminium

### Lengths

Top / Mid Profiles: 4100mm

Vertical Profiles: 4200mm

Wall Profile: 3900mm



Hadleigh  
Top Profile



# CODES & DESCRIPTIONS

## TOP PROFILES - FOR BASE CABINETS

CODE	DESCRIPTION
<b>VTOP4100</b>	Top profile for doors, 4100mm(L) x 56.5mm(H) x 27.2mm(D), aluminium
<b>VTOPENDCAP</b>	End cap for top profile, aluminium - pair (1 LH, 1 RH)
<b>VTOPINT90</b>	Internal corner joint for top profile, 90 degrees, aluminium
<b>VTOPEXT90</b>	External corner joint for top profile, 90 degrees, aluminium
<b>VTOPJOINT</b>	Joint section for top profile, aluminium
<b>VQFIX</b>	Quick fix brackets for top and mid profiles, screw mounted - 1 pair (minimum order 25 pairs)

## MID PROFILES - FOR DRAWERS

CODE	DESCRIPTION
<b>VMID4100</b>	Mid profile for drawers, 4100mm(L) x 73mm(H) x 26mm(D), aluminium
<b>VMIDENDCAP</b>	End cap for mid profile, aluminium - pair (1 LH, 1 RH)
<b>VMIDINT90</b>	Internal corner joint for mid profile, 90 degrees, aluminium
<b>VMIDEXT90</b>	External corner joint for mid profile, 90 degrees, aluminium
<b>VQFIX</b>	Quick fix brackets for top and mid profiles, screw mounted - 1 pair (minimum order 25 pairs)

## VERTICAL PROFILES - FOR TALL CABINETS

CODE	DESCRIPTION
<b>VVERTMID4200</b>	Vertical profile intermediate, 4200mm(L) x 71.6(H) x 41mm(D), aluminium
<b>VVERTEND4200</b>	Vertical profile lateral, 4200mm(L) x 53.3mm(H) x 41mm(D), aluminium
<b>VVERTSPACER</b>	Spacer for appliance, 580mm(L) x 19.6mm(H) x 20.8mm(D), aluminium

## WALL CABINET PROFILES

CODE	DESCRIPTION
<b>VWALL3900</b>	Wall cabinet profile, 3900mm(L) x 19.6mm(H) x 20mm(D), aluminium



# PRODUCT RANGE OVERVIEW

## Top Profile & Accessories:

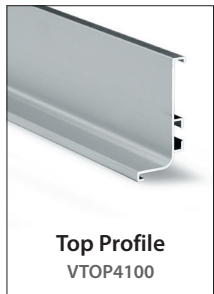

Used for base units  
(4100mm length)



Used to finish  
off top profiles



Connects top  
profiles at internal  
corners



Connects top  
profiles at  
external corners



Connects  
lengths of top  
profiles

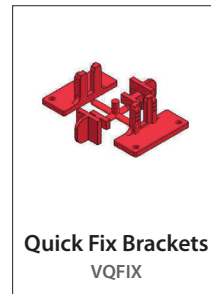

Used to attach  
profile to cabinet  
(screw mounted)

## Mid Profile & Accessories:



Used for drawers  
(4100mm length)



Used to finish  
off mid profiles



Connects mid  
profiles at internal  
corners



Connects mid  
profiles at  
external corners

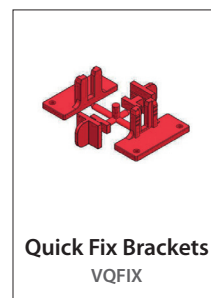

Used to attach  
profile to cabinet  
(screw mounted)

## Vertical Profiles & Accessories:

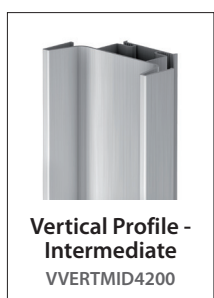

Used between two  
larger units  
(4200mm length)



Used with one  
larger unit  
(4200mm length)



Conceals gap  
behind appliances  
(580mm length)

## Wall Profile:



Used for wall units  
(3900mm length)



## Top Profile

### Code

VTOP4100

### Finish / Material

Aluminium

### Dimensions

4100 x 56.5 x 27.2mm

### Accessories available

Quick Fix Brackets, code: VQFIX

End Cap - Top, code: VTOPENDCAP

Internal Corner Joint - Top, code: VTOPINT90

External Corner Joint - Top, code: VTOPEXT90

Joint Section, code: VTOPJOINT



- Used for base unit doors and top drawers.
- Can be cut to size using a circular chop saw.
- Secured to cabinets with Quick Fix Brackets.
- Profiles can be finished off with End Caps before fitting.
- Top profiles can be linked at internal and external corners using Corner Joints.
- Straight lengths of top profiles can be linked together using the Joint Section.

### DIMENSIONS

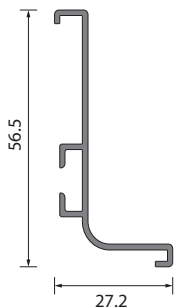

### FITTED DETAIL

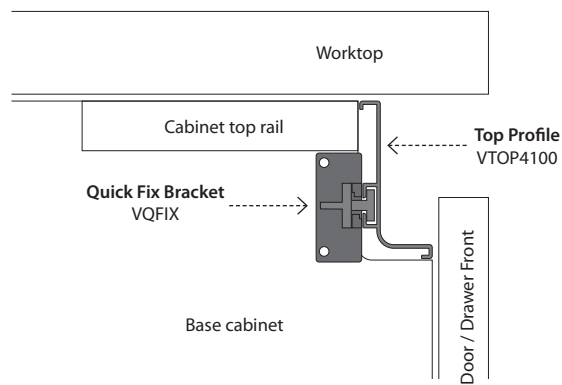

### BASE CABINET ROUTING

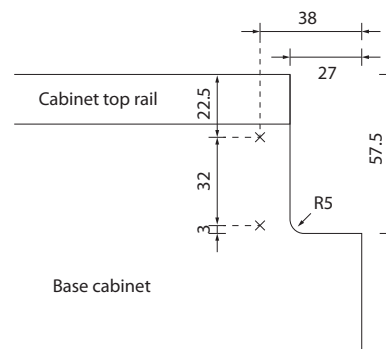

### BASE CABINET DIMENSIONS

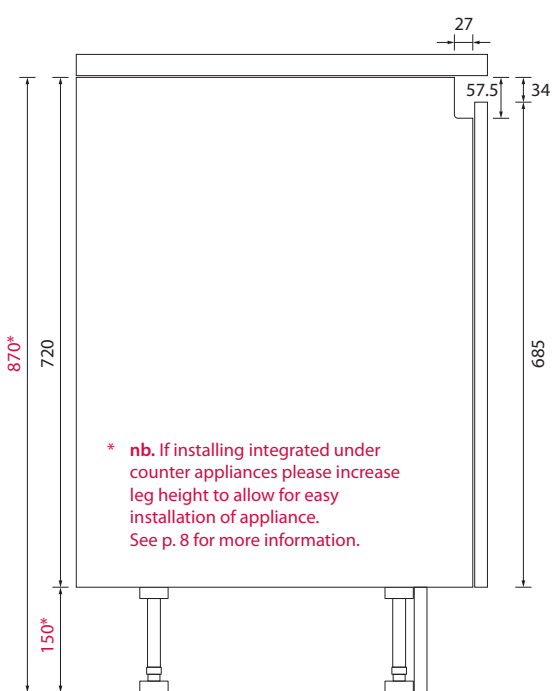

### BASE UNIT COMPONENTS

1. Top Profile (VTOP4100)
2. Internal Corner Joint - Top (VTOPINT90)
3. External Corner Joint - Top (VTOPEXT90)
4. Quick Fix Bracket (VQFIX)
5. End Cap - Top (VTOPENDCAP)

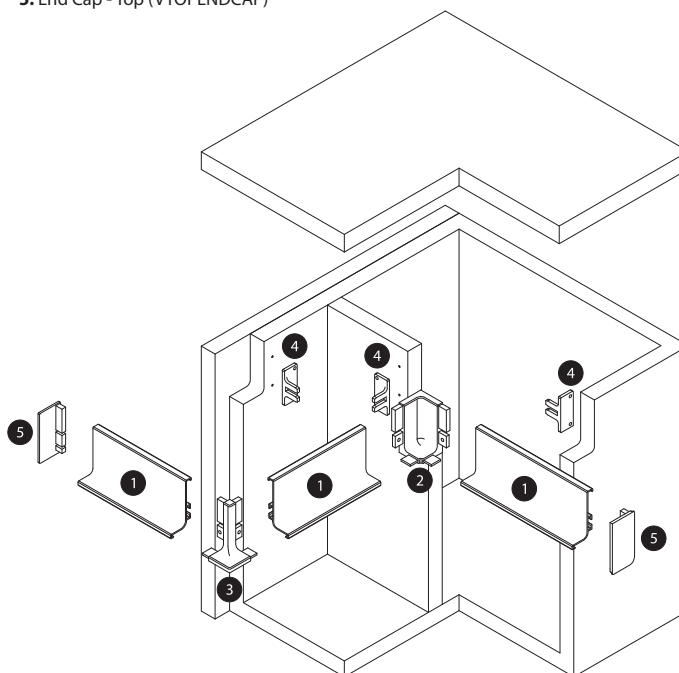

## Mid Profile

### Code

VMID4100

### Finish / Material

Aluminium

### Dimensions

4100 x 73 x 26mm

### Accessories available

Quick Fix Brackets, code: VQFIX

End Cap - Mid, code: VMIDENDCAP

Internal Corner Joint - Mid, code: VMIDINT90

External Corner Joint - Mid, code: VMIDEXT90



- Used for mid and bottom drawers.
- Can be cut to size using a circular chop saw.
- Secured to cabinets with Quick Fix Brackets.
- Profiles can be finished off with End Caps before fitting.
- Mid profiles can be linked at internal and external corners using Corner Joints.

### DIMENSIONS

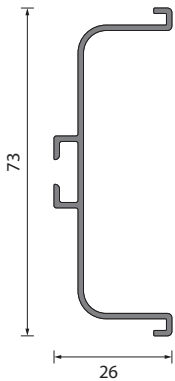

### FITTED DETAIL

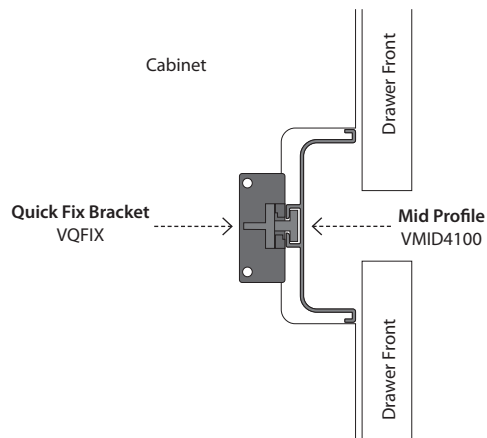

### BASE CABINET ROUTING

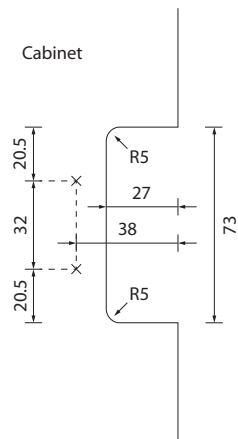

### BASE CABINET DIMENSIONS

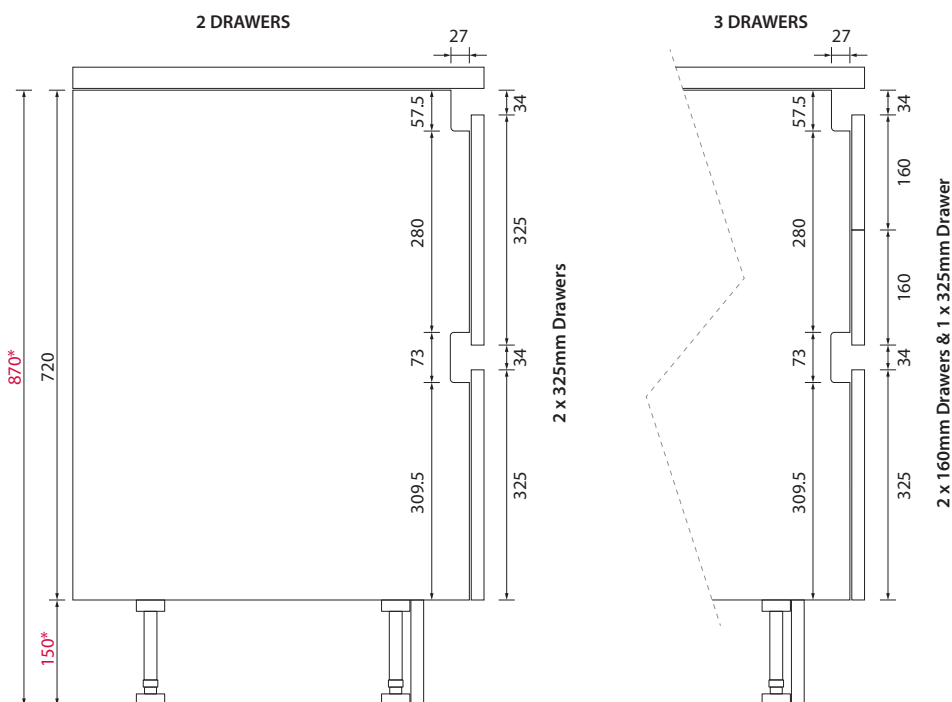

\* **nb.** If installing integrated under counter appliances please increase leg height to allow for easy installation of appliance. See p. 8 for more information.



## Installing under counter appliances

### Integrated dishwasher

- The Top Profile (VTOP4100) can be used to run above an integrated appliance.
- It is recommended to **set integrated dishwasher height at 815mm** and adjust carcass legs to a min. height of 155mm. Please note, these dimensions are based on standard height dishwasher. Cabinet legs may need to be raised further if appliance height is different.
- Metal brackets (supplied with dishwasher) should be fixed to the outer face of adjacent cabinets. Please note, an additional bracing baton may be required to the rear of the machine to help reduce movement.
- If drawers are situated next to an integrated appliance, we recommend using end caps to cover any gaps.

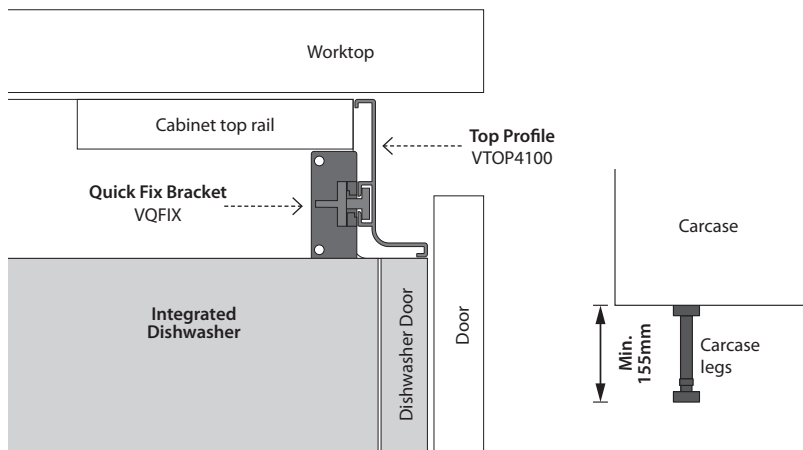

### IMPORTANT INFORMATION

We recommend extending the cabinet legs to a minimum height of 155mm to ensure the integrated dishwasher will fit easily.

**Always** check the minimum height of your under counter appliances before installing your Hadleigh kitchen to ensure there is enough clearance under the top rail.



### Under mounted oven

- The Top Profile (VTOP4100) can't be used in conjunction with an under mounted oven. Profiles must stop on each side of the appliance and can be finished with End Caps.
- If using a freestanding cooker, end panels will need to be fitted on either side of the appliance and the profile needs to be finished against the panel.

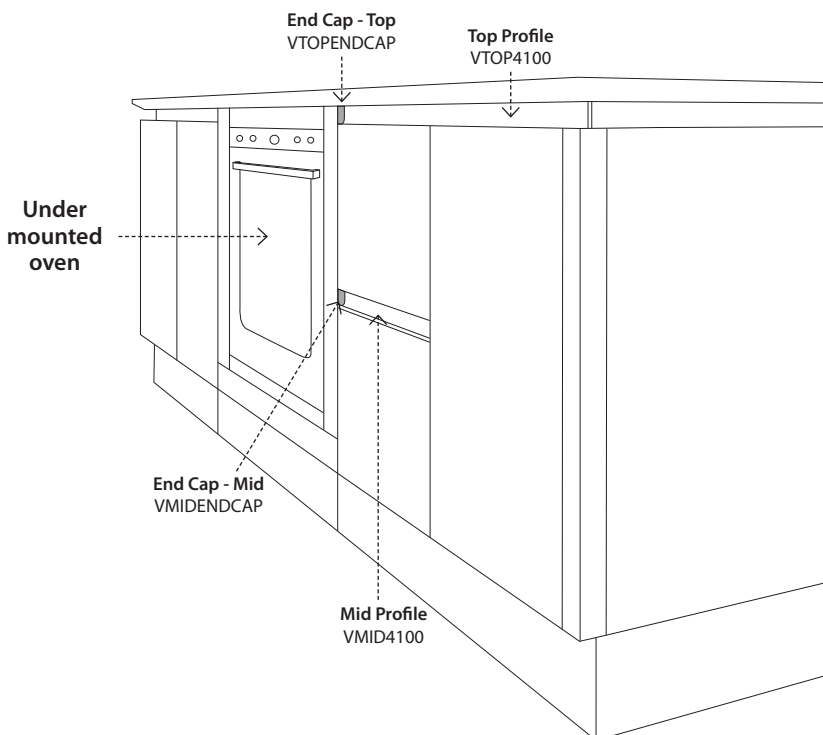



## Vertical Profile - Intermediate

**Code**  
WVERTMID4200

**Finish / Material**  
Aluminium

**Dimensions**  
4200 x 71.6 x 41mm

**Accessories available**  
WVERTSPACER



- Used on tall units when two opening doors meet.
- Secured to cabinet gables with 25mm cabinet screws.
- Can be cut to size using a circular chop saw.
- A 35mm spacer (not supplied) is required at the back between the two cabinets to maintain the void created by the profile trim.
- The front of the cabinet gables are set back by 20mm for the trim to overlap behind the doors

### DIMENSIONS

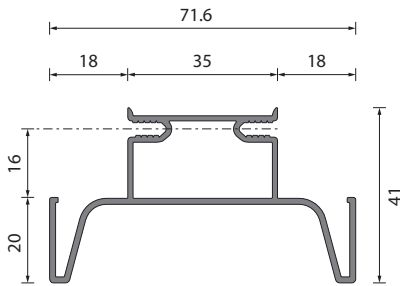

### FITTED DETAIL

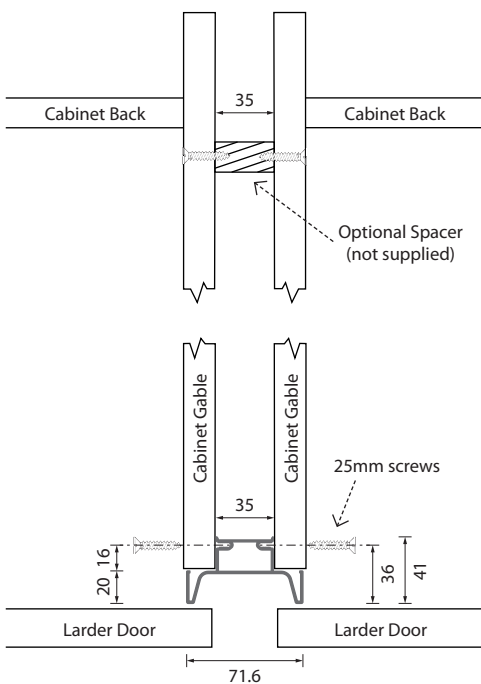

### APPLICATION BETWEEN TWO DOORS

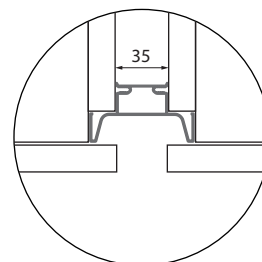
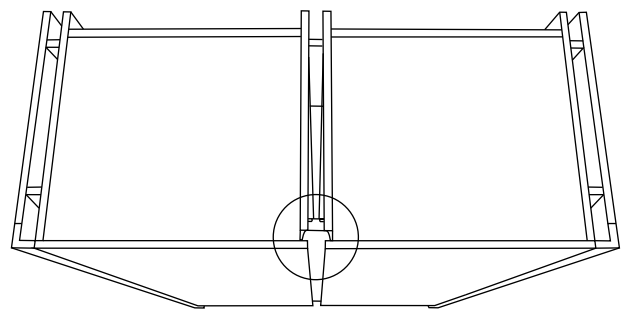

Don't forget to add 35mm spacing in between larder units.



## Vertical Profile - Lateral

**Code**  
VVERTEND4200

**Finish / Material**  
Aluminium

**Dimensions**  
4200 x 53.3 x 41mm

**Accessories available**  
VVERTSPACER



- Used on tall units when you have an opening door on one side only, can also be used to end a run where an end post or end panel is fitted.
- Secured to cabinet gable with 25mm cabinet screws.
- Can be cut to size using a circular chop saw.
- A 35mm spacer (not supplied) is required at the back between two cabinets, or between a cabinet and end panel.
- The front of the cabinet gable is set back by 20mm for the trim to overlap behind the door.
- To fix an end post or end panel to the profile you need to drill through the screw support channel and attach the end post from the inside of the cabinet with a 60mm screw.

### DIMENSIONS

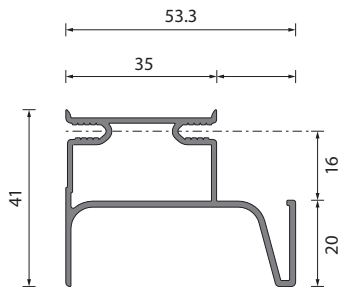

### FITTED DETAIL

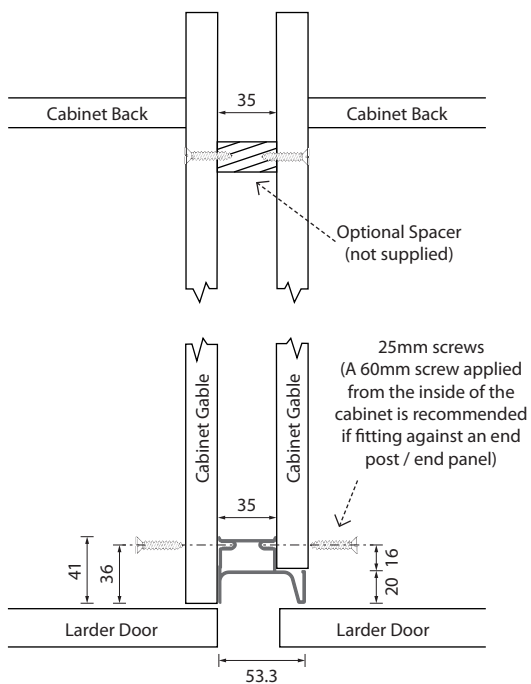

### APPLICATION BETWEEN TWO DOORS

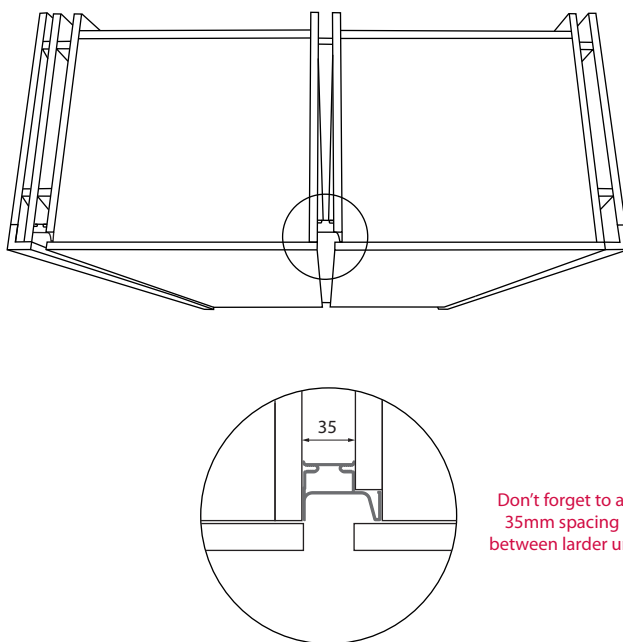

## Spacer for Appliance

**Code**  
VVERTSPACER

**Finish / Material**  
Aluminium

**Dimensions**  
580 x 19.6 x 20.8mm



- Used to conceal the space behind the front of an appliance when used in an appliance housing unit combined with vertical Hadleigh profiles.
- Fixed into the cabinet gable with 3 screws (4 x 16mm).
- Works with both intermediate and lateral vertical profiles.
- The trim can be cut down to suit different sized appliances. If doing so, we recommend that a metal file is used to remove any sharp edges on the cut edge and that it is positioned out of sight.
- If the appliance requires a screw fixing into the cabinet, the spacer can be drilled into to accommodate the screws.
- **Nb.** When stacking appliances, we recommend leaving a 10mm gap to the top and bottom of both appliances.

### DIMENSIONS

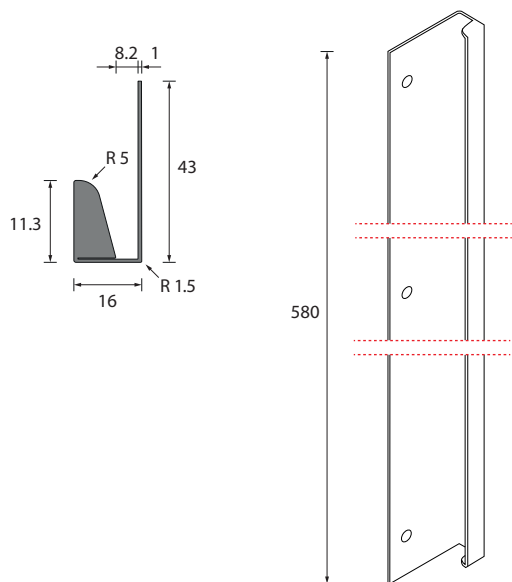

### FITTED DETAIL

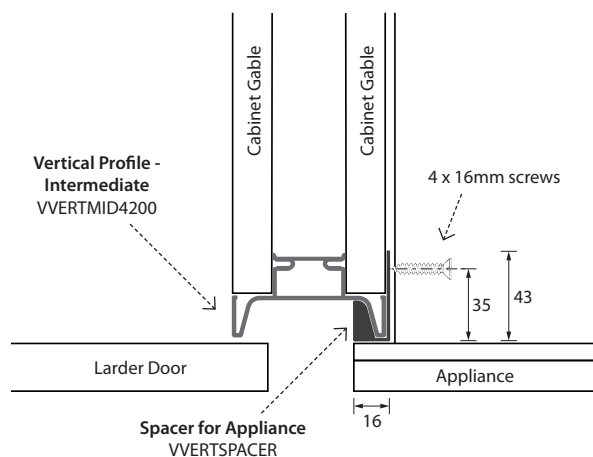

### APPLIANCE INSTALLATION

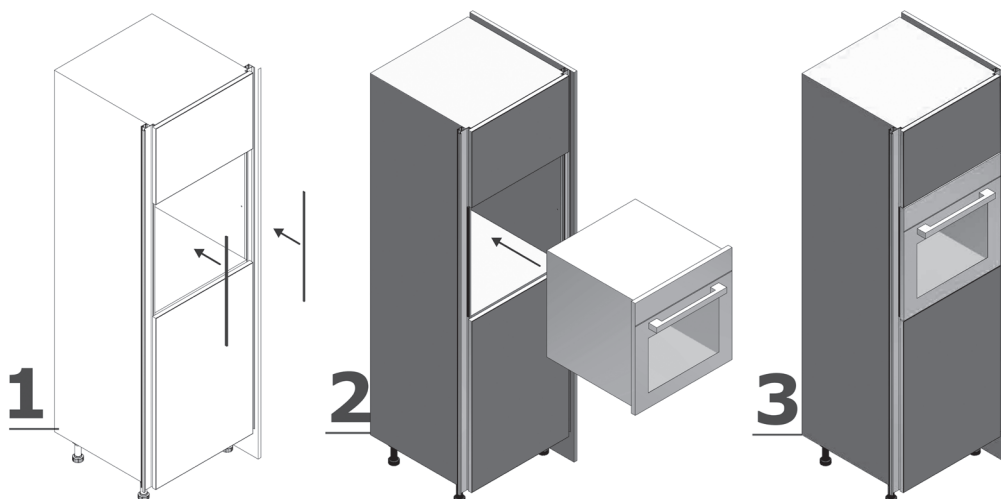

## Wall Cabinet Profile

**Code**  
VWALL3900

**Finish / Material**  
Aluminium

**Dimensions**  
3900 x 19.6 x 20mm

**Accessories available**  
N/A

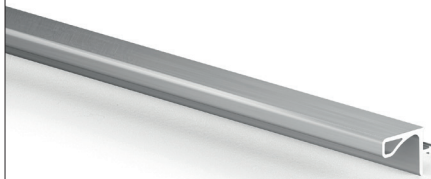

- Concealed rail used on wall units.
- Can be cut to size using a circular chop saw.
- The base panel on the wall cabinet is set back with 20mm to accommodate the rail profile within the cabinet.
- They also have an 8mm deep, 3mm high pre-routed groove for the profile to slot into.
- Clear silicone adhesive should be used to bind the rail with the panel.

### DIMENSIONS

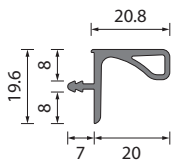

### FITTED DETAIL

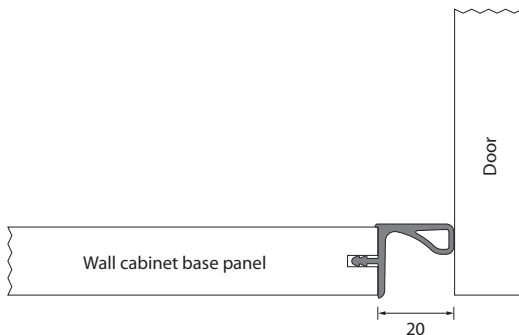

### CABINET ROUTING

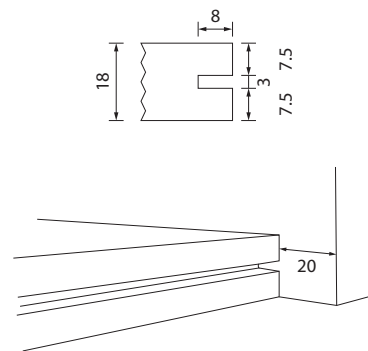

Hadleigh true handleless kitchen with gloss Cashmere doors





## Quick Fix Brackets

**Code**  
VQFIX

**Finish / Material**  
Plastic

**Dimensions**  
N/A

**Accessories available**  
N/A

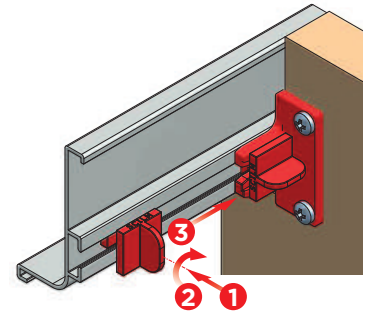
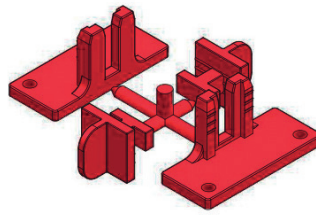

- Screw mounted brackets for top and mid profiles.
- Comes in pairs (min. order 25 pairs).

### FITTING TOP AND MID PROFILES

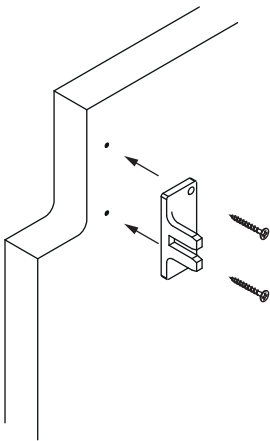

**Step 1.**  
Attach quick fix brackets (VQFIX) to routed cabinet gables using screws.

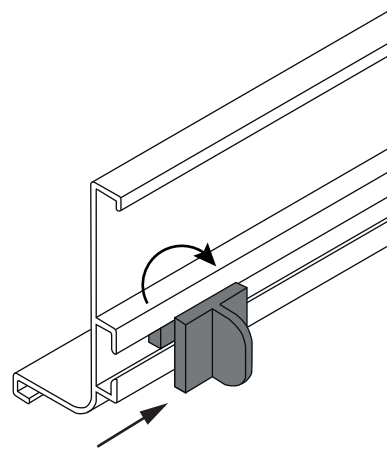

**Step 2.**  
Slide the connectors into the back of the profile and turn 90 degrees.

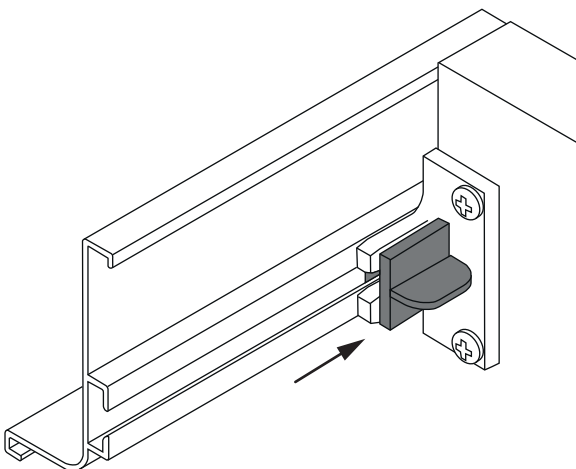

**Step 3.**  
Apply profile to routed cabinet and push connectors into brackets to secure the profile to the cabinet.



### External Corner Joint - Top

**Code**  
VTOPEXT90

**Finish / Material**  
Aluminium

- Used to connect two top profiles running around an external corner or an island unit, to be used together with an external corner post.
- Secured to the top profile using two screws (supplied).
- **Nb.** A cut out needs to be made on the routed gable end to accommodate the screw heads behind the external corner joint (see Diagram 1 below).

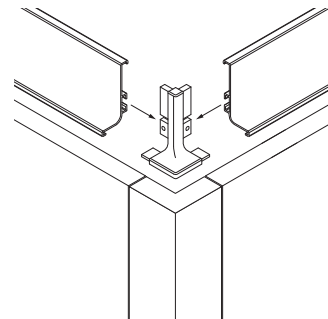
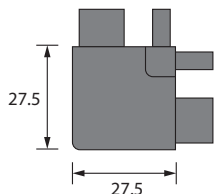

### External Corner Joint - Mid

**Code**  
VMIDEXT90

**Finish / Material**  
Aluminium

- Used to connect two mid profiles running around an external corner or an island unit, to be used together with external corner posts.
- Secured to the mid profile using two screws (supplied).
- **Nb.** A cut out needs to be made on the routed gable end to accommodate the screw heads behind the external corner joint (see Diagram 1 below).

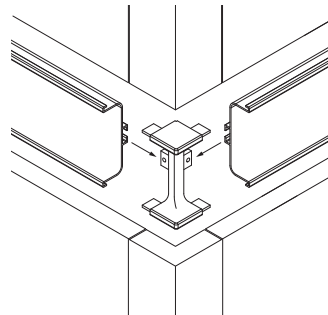
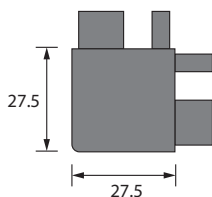
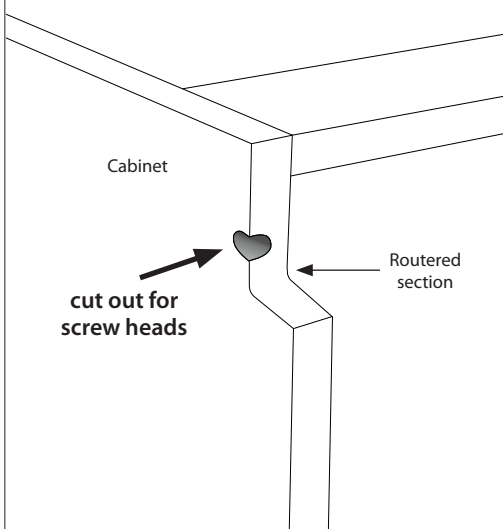
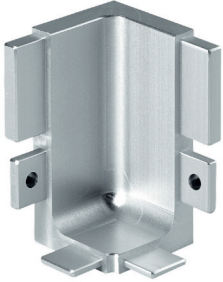
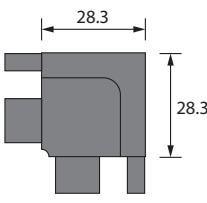
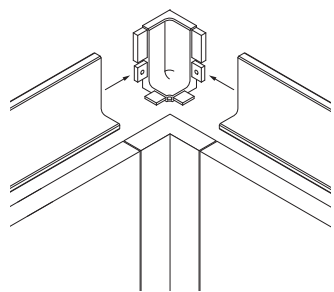



DIAGRAM 1



Before applying the corner joints to the cabinets, a hole needs to be notched out of the routed gable end to accommodate the two screw heads at the back of the corner joints.

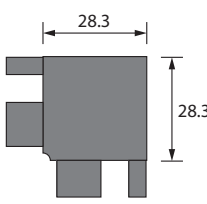
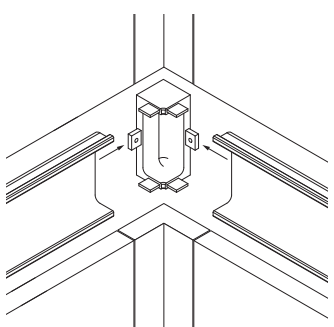

<h3>Internal Corner Joint - Top</h3>	
<p><b>Code</b> VTOPINT90</p> <p><b>Finish / Material</b> Aluminium</p>	<ul style="list-style-type: none"> <li>Used to connect two top profiles at an internal corner, to be used together with an internal corner post.</li> <li>Secured to the top profile using two screws (supplied).</li> </ul>
  	

<h3>Internal Corner Joint - Mid</h3>	
<p><b>Code</b> VMIDINT90</p> <p><b>Finish / Material</b> Aluminium</p>	<ul style="list-style-type: none"> <li>Used to connect two mid profiles at an internal corner, to be used together with internal corner posts.</li> <li>Secured to the mid profile using two screws (supplied).</li> </ul>
  	

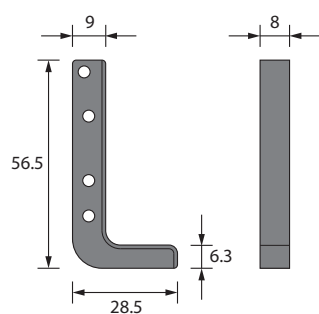
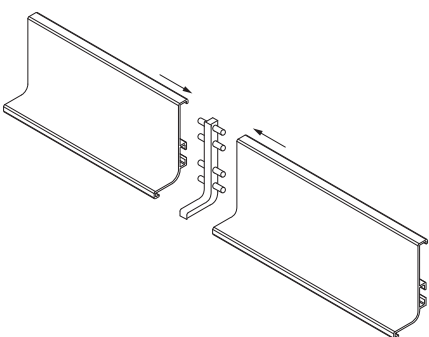
<h3>Top Joint</h3>	
<p><b>Code</b> VTOPJOINT</p> <p><b>Finish / Material</b> Aluminium</p>	<ul style="list-style-type: none"> <li>Used to join together lengths of top profiles.</li> <li>Held in place with 4 grub screws (supplied). Grub screw secured with Allen key.</li> <li>When using top joints an 8mm spacing must be taken into account when cutting down the profiles that are being joined together.</li> </ul>
  	



<b>End Caps - Top</b>			
<p><b>Code</b> VTOPENDCAP</p> <p><b>Finish / Material</b> Aluminium</p>	<ul style="list-style-type: none"> <li>Used at the end of a top profile for example against a wall, end panel or next to appliances such as under mounted oven.</li> </ul>	<ul style="list-style-type: none"> <li>Secured to the top profile using a grub screw (supplied). Grub screw secured with Allen key.</li> </ul>	<ul style="list-style-type: none"> <li>When using end caps, a 2mm spacing must be taken into account when cutting down the trim.</li> </ul>

<b>End Caps - Mid</b>			
<p><b>Code</b> VMIDENDCAP</p> <p><b>Finish / Material</b> Aluminium</p>	<ul style="list-style-type: none"> <li>Used at the end of a mid profile for example against a wall, end panel or next to appliances such as an under mounted oven.</li> </ul>	<ul style="list-style-type: none"> <li>Secured to the mid profile using a grub screw (supplied). Grub screw secured with Allen key.</li> </ul>	<ul style="list-style-type: none"> <li>When using end caps, a 2mm spacing must be taken into account when cutting down the trim.</li> </ul>





# Door Configurations

## Door & drawer configurations available for the Hadleigh true handleless rail system

### HADLEIGH BASE & WALL UNIT CONFIGURATIONS

Standard height installation (1970mm) & extra tall height installation (2150mm).

All dimensions shown in mm.

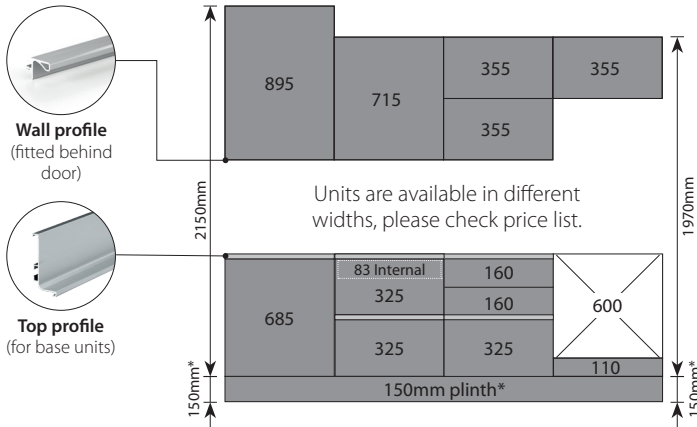

Hadleigh wall unit door sizes are the same as standard door sizes as the Hadleigh wall profile is fitted behind the door.

Hadleigh base unit doors are designed specifically to suit Hadleigh base profiles and are shorter than standard doors, using 685mm rather than 715mm.

### HADLEIGH LARDER & APPLIANCE UNIT CONFIGURATIONS

Standard height installation (1970mm).

FH30S-FH60S FH30D-FH60D	L30S-L60S L30D-L60D	FF50S FF50D	FF70S FF70D	FF90S FF90D	TOVENAS TOVENAD	TOVENBS TOVENBD	TOVENC TOVENC	TOVENDS TOVENDD
1965 Available widths: 300 400 500 600	1245 Available widths: 300 400 500 600	980	1245	175 filler 895	490	645	490	450
	715	980	715	895	900	600	380 600	460 600
					570	715	490	450
150mm plinth*								
Larder Unit, Full Height Doors (Slab only)	Larder Unit 70/30	Fridge / Freezer 50/50 (980 doors)	Fridge / Freezer 70/30	Fridge / Freezer 50/50 (895 doors)	Double Oven	Single Oven	Single Oven & 380mm Micro	Single Oven & 460mm Micro

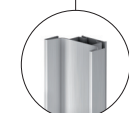

Vertical profile (for larder/appliance units)

Hadleigh larder & appliance unit door sizes are the same as standard door sizes.

### EXTRA TALL HADLEIGH LARDER & APPLIANCE UNIT CONFIGURATIONS

Extra tall height installation (2150mm).

TL30S-TL60S TL30D-TL60D	TFF50S TFF50D	TFF70S TFF70D	TTOVENAS TTOVENAD	TTOVENBS TTOVENBD	TTOVENC TTOVENC	TTOVENDS TTOVENDD
1245 Available widths: 300 400 500 600	175 filler 980	1245	715	490	570	490
			600 filler 110	900 filler 175	380 600	460 600
			715	570	570	140 450
150mm plinth*						
Larder Unit	Fridge / Freezer 50/50	Fridge / Freezer 70/30	Single Oven	Double Oven	Single Oven & 380mm Micro	Single Oven & 460mm Micro

This code is unique to this appliance unit & added to the end of the order code. Codes ending with an 'S' is a single gable and ending in a 'D' is a double gable.

NB: This page is to show door configurations only. Appliance heights will vary and may have an impact on filler / door sizes. Please check appliance heights and specifications before purchasing and installing any units to ensure they fit the door configurations specified and are suitable for your requirements.

\* Cabinet leg height required may vary. If integrated under counter appliances are installed, please raise cabinet legs with min. 10mm (throughout the kitchen) to ensure the appliance fits easily underneath the top rail.

